

GENERAL NOTES

- A. COORDINATE WITH CIVIL, STRUCTURAL, MECHANICAL, ELECTRICAL, PLUMBING & LANDSCAPE.
- B. SOME KEYED NOTES MAY NOT BE USED.
- D. PROVIDE REASONABLE ACCESS TO ALL EXISTING RESTAURANTS. COORDINATE WITH ART INSTITUTE.
- E. PROTECT ALL IMPROVEMENTS ON ADJACENT PROPERTIES. REPLACE IF DAMAGED.
- G. PATCH ALL CUT OR DAMAGED ASPHALT FOR SMOOTH DRIVE TRANSITION.
- H. NOTIFY THE OWNER IF AN UNIDENTIFIED UTILITY LINE IS WITHIN THE CONSTRUCTION AREA.
- I. PROVIDE VERTICAL AND HORIZONTAL DATA ON ALL CAPPED UTILITY LINES.
- J. ALL INTERIOR PARKING ISLANDS REFER TO DETAILS SHEET AS-501.
- K. ALL PERIMETER CURB AND GUTTER DETAILS PER CITY OF SANTA FE STANDARD DETAILS.

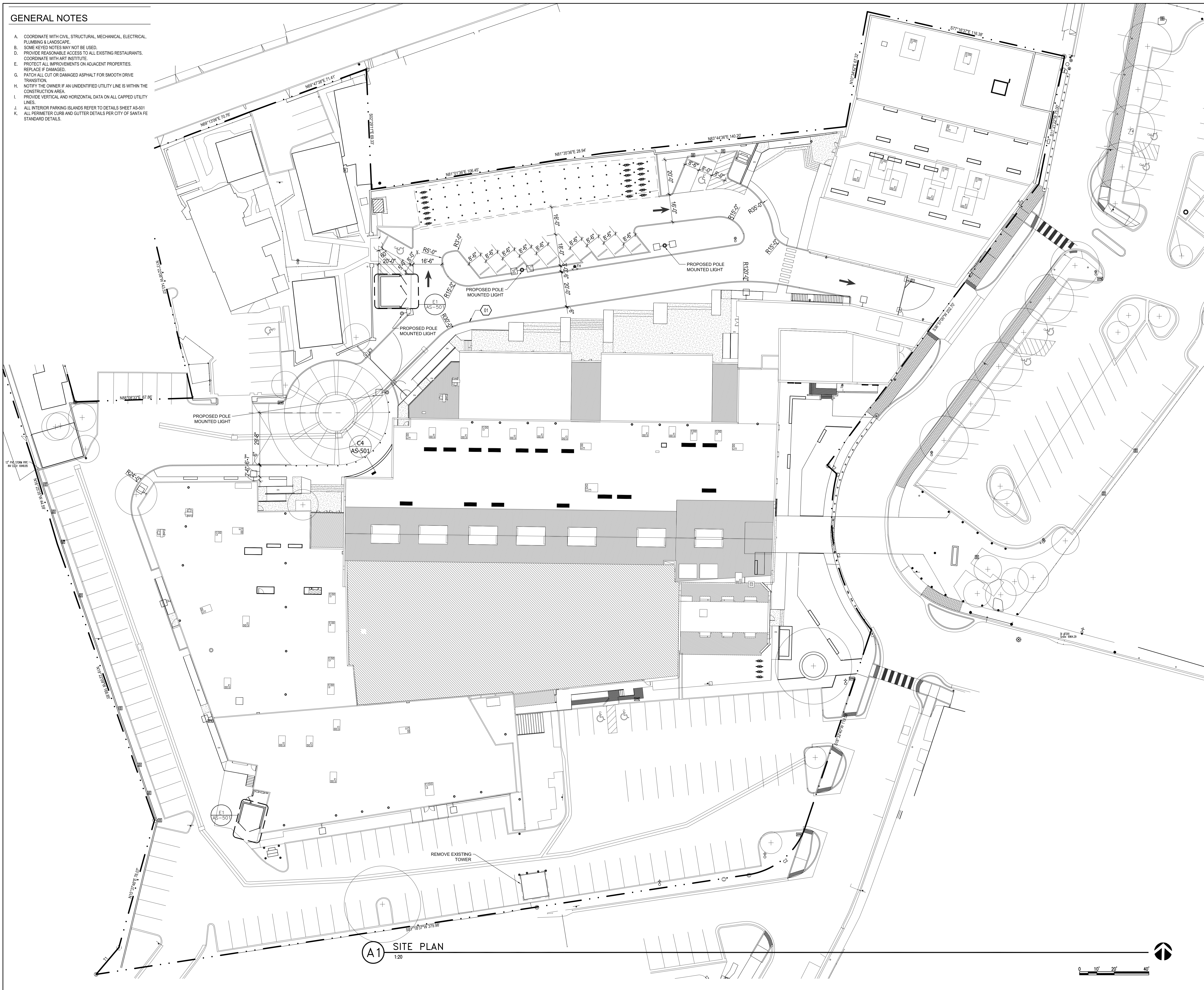

A1 SITE PLAN
1:20

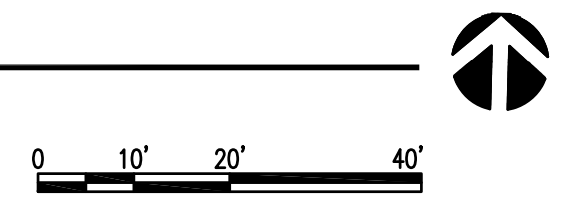

STUDIO SOUTHWEST ARCHITECTS, INC.
2101 Mountain Rd. NW, Albuquerque, NM 87104
505.843.9839 Fax 505.843.9863
Web Site: www.studioswarch.com
Email: mail@studioswarch.com

© 2014, Studio Southwest Architects, Inc.
Duplication or reproduction by any means without the express written consent of Studio Southwest Architects, Inc. is a violation of federal and international law. The information contained in this document is the intellectual property of Studio Southwest, Inc. and all rights thereto are Reserved. For exceptions refer to the Owner-Architect Agreement.

CONSULTANTS

ARCHITECTS INC.

LAKE FLATO
311 THIRD STREET
SAN ANTONIO, TEXAS 78205
P.210.227.3335 F.210.224.9515
www.lakeflato.com

Architect Engineer

NEW MEXICO SCHOOL FOR THE ARTS - PHASE 1

500 - 550 Montezuma Ave
Santa Fe, NM 87501

Key Plan

NTS

No	Date	Description
Revision Schedule		
ISSUE:	HDRB	
PROJECT NUMBER:	1605	
FILE:		
DRAWN BY:		
CHECKED BY:		
DATE:	MARCH 13, 2017	

SHEET TITLE

SITE PLAN

AS-101